



eco lift

Product Catalogue



# eco lift



## Elevators

- Dumbwaiters
- Traction Elevators
- MRL Elevators
- Hydraulic Elevators
- Panoramic Elevators
- Disabled Elevators
- Stairlifts



## Escalators Moving Walkways



## Elevator Components

- Elevator Cabins
- Geared and Gearless Motors
- Elevator Controllers
- Automatic Doors
- Guide Rails
- Elevator Ropes
- Elevator Cables
- Elevator COP and Buttons

**“Control the motion”**



# ABOUT US

Ecolift Elevator Company is in the business of providing the highest quality elevator and escalator products and services. We will conduct our business with integrity and will act with honesty and respect in dealing with customers, employees, and business partners.

Ecolift Elevator has a well-earned reputation for quality, reliability, and value. We always abide by the doctrine of existence and growth on quality. Our total commitment is reflected in our quick response time, consistent and advanced technical expertise, and minimization of service interruptions.

We offer customer based solutions for different projects such as special elevators , escalators and moving walkways.

## Why Choose Ecolift ?

As a Ecolift Elevator customer, you benefit from high quality, effective service and competitive prices as well as;

### Approved quality

1

We make control for each step of production from starting to packing

### Special Design

3

Customized approach for the design , research, documentation and manufacturing of lifts

2

### Prompt response

You have to get response for any queries within 24 hours

4

### Continuous feedback

Continuous feedback during order, production, shipment and installation period



ECO - 01



# FOREST SERIES

ECO - 02



# FOREST SERIES

ECO - 03



# FOREST SERIES

ECO - 04



# FOREST SERIES

ECO - 05



# FOREST SERIES

ECO - 06



# FOREST SERIES

ECO - 07



# INOX SERIES

ECO - 08



# INOX SERIES

ECO - 09



# INOX SERIES

ECO - 10



# INOX SERIES

ECO - 11



# PRESTIGE SERIES

ECO - 12



# PRESTIGE SERIES

ECO - 13

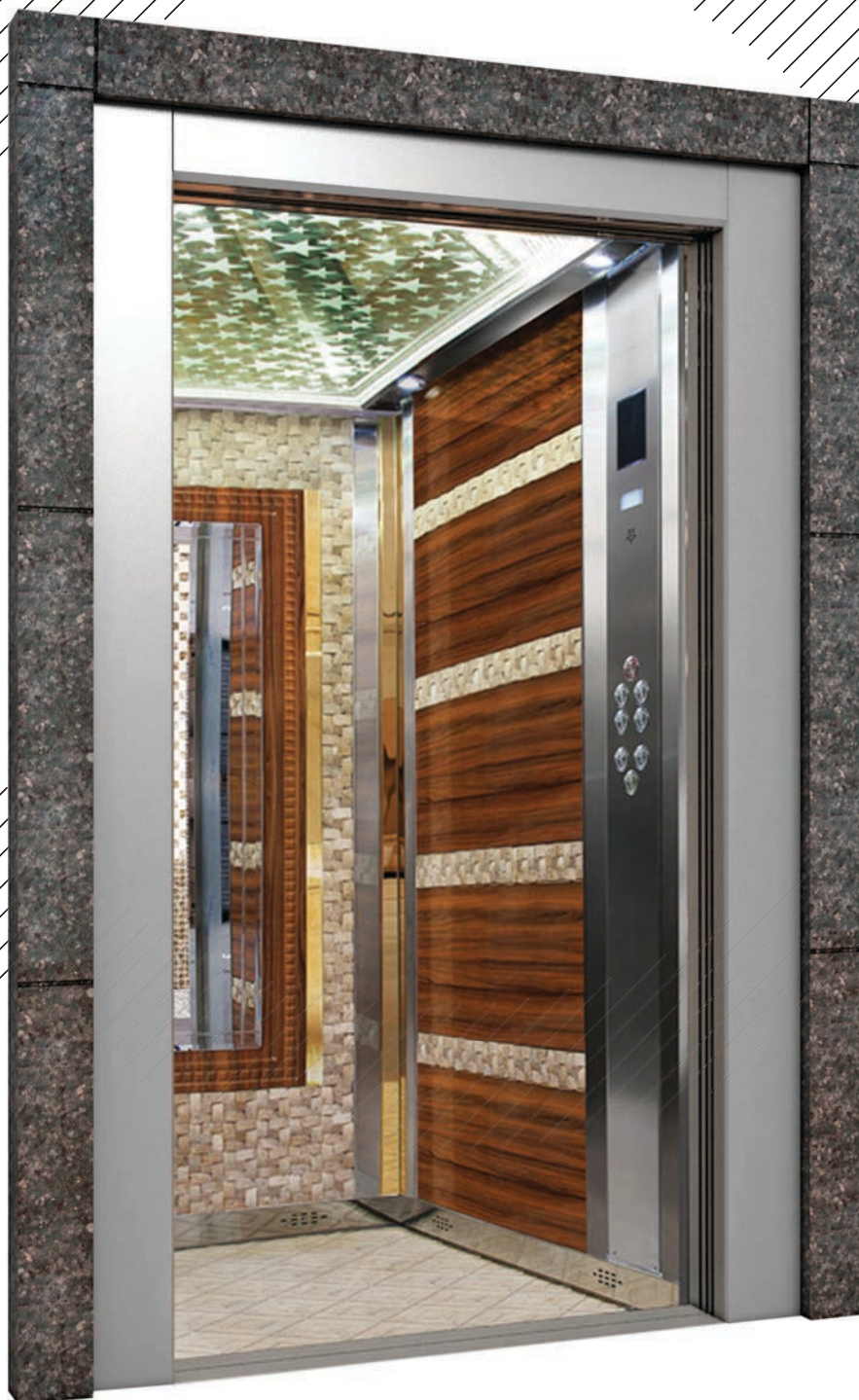

# PRESTIGE SERIES

ECO - 14



# PRESTIGE SERIES

ECO - 15



# PRESTIGE SERIES

ECO - 16



# PRESTIGE SERIES

KITCHEN SERIES

ECO - 17



ECO - 18



KITCHEN SERIES

CARGO SERIES

ECO - 19



ECO - 20



CARGO SERIES

# PANORAMIC

ECO - 21



ECO - 22



# PANORAMIC

PANORAMIC

ECO - 23



ECO - 24



PANORAMIC

# PANORAMIC

ECO - 25



ECO - 26



# PANORAMIC

PANORAMIC

ECO - 27



ECO - 28



PANORAMIC

## CEILING/ FLOOR TYPES

[ ETA - 101 ]



[ ETA - 102 ]

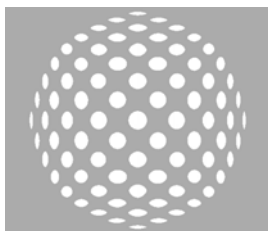

[ ETA - 103 ]



[ ETA - 104 ]



[ ETA - 105 ]



[ ETA - 106 ]

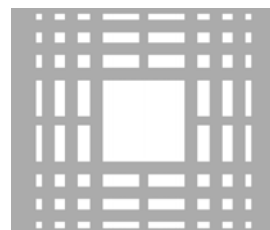

[ ETA - 107 ]



[ ETA - 108 ]



[ ETA - 109 ]

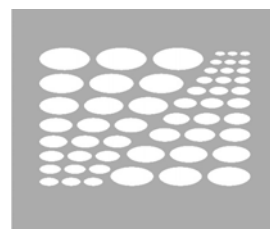

[ ETA - 110 ]



[ ETA - 111 ]



[ ETA - 112 ]



[ ETB - 101 ]

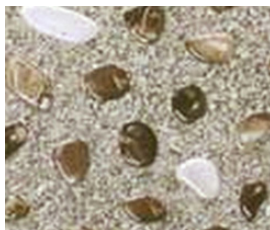

[ ETB - 102 ]

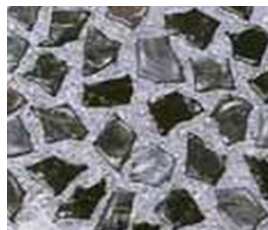

[ ETB - 103 ]

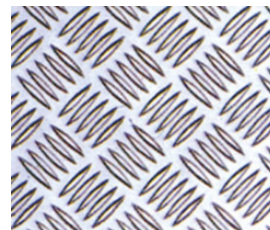

[ ETB - 104 ]

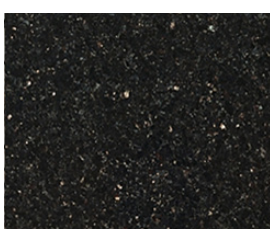

[ ETB - 105 ]

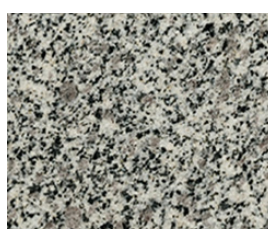

[ ETB - 106 ]

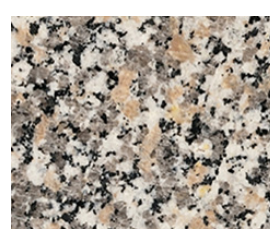

# LAMINATE / STAINLESS COATING

[ ELK - 101 ]



[ ELK - 102 ]



[ ELK - 103 ]



[ ELK - 104 ]



[ ELK - 105 ]



[ ELK - 106 ]



[ EPK - 101 ]

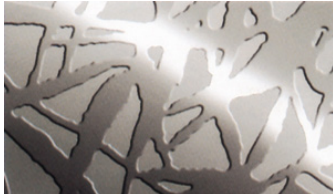

[ EPK - 102 ]



[ EPK - 103 ]



[ EPK - 104 ]



[ EPK - 105 ]

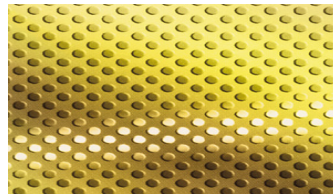

[ EPK - 106 ]



[ EDK - 101 ]



[ EDK - 102 ]



[ EDK - 103 ]



# FRAMES

## CABIN FRAME



## COUNTERWEIGHT FRAME

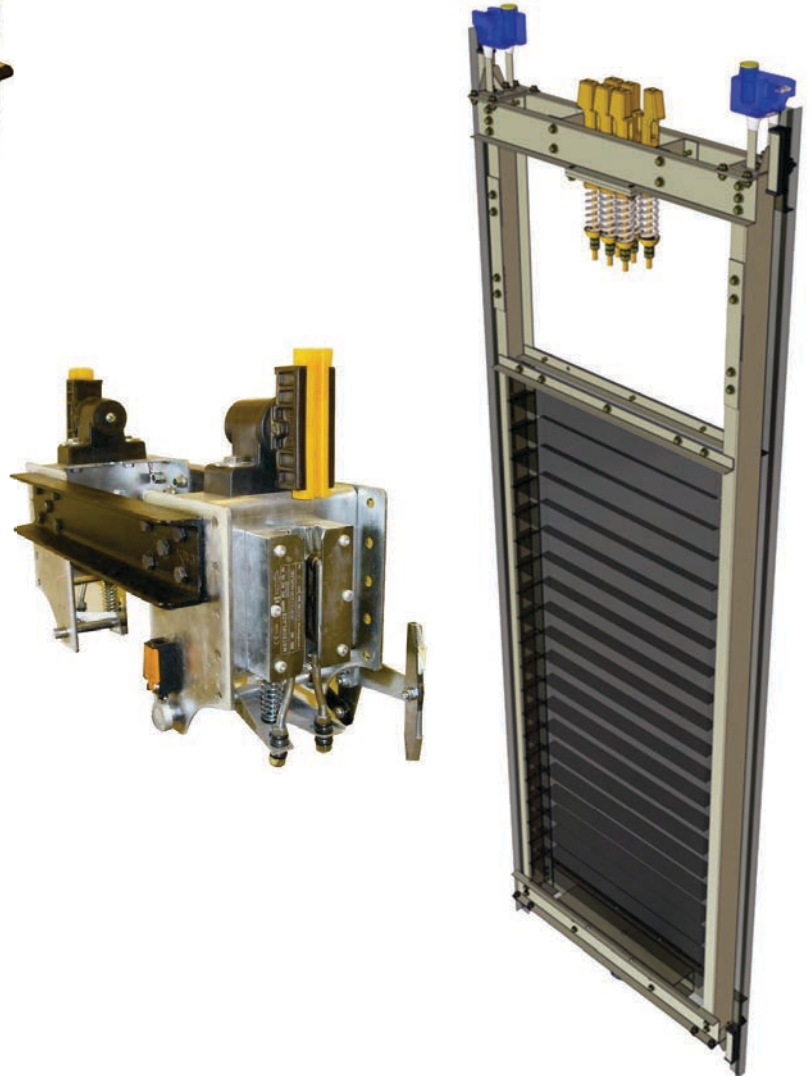

## SAFETY GEARS

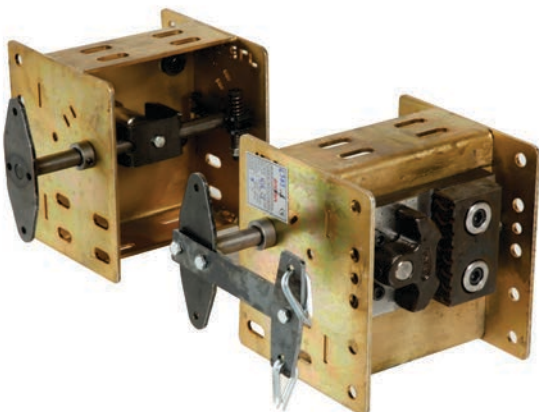

### DATA / TYPE

Slide-way head thickness  
 Carrying capacity- min a max (P+Q)  
 Max. Tripping speed  
 Slide-way surface quality  
 Minimal width of catching surface  
 Guiding surfaces lubrication  
 Manufacturing No/ Year of production

### EM-KA 9

9 mm  
 1300kg  
 2,55 m/s  
 Cold-Drawn / Machined  
 25mm  
 HLP 32, HLP 46  
 140001

### DATA / TYPE

Slide-way head thickness  
 Carrying capacity- min a max (P+Q)  
 Max. Tripping speed  
 Slide-way surface quality  
 Minimal width of catching surface  
 Guiding surfaces lubrication  
 Manufacturing No/ Year of production

### EM-KA 16

16 mm  
 3000kg  
 2,16 m/s  
 Cold-Drawn / Machined  
 25mm  
 HLP 32, HLP 46  
 140002

# SUSPENSION

1:1 MR

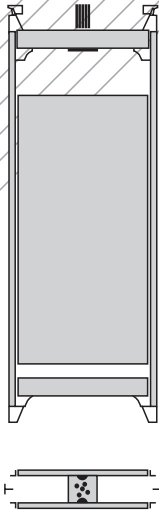

2:1 MR

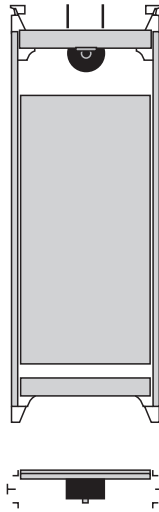

2:1 MR



4:1 MR

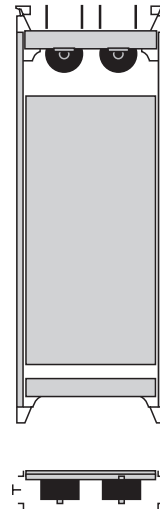

2:1 MR

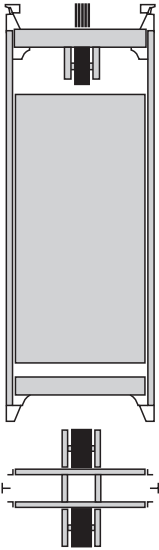

1:1 HDR

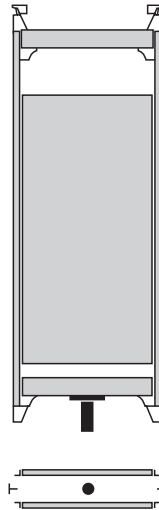

2:1 MRL

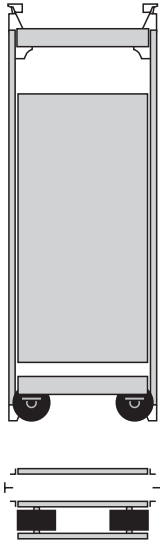

4:1 MRL

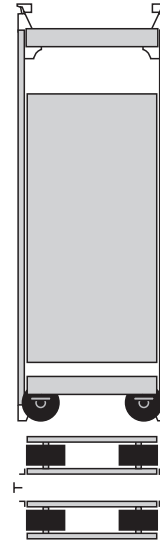

2:1 L HDR



1:1 L MRL

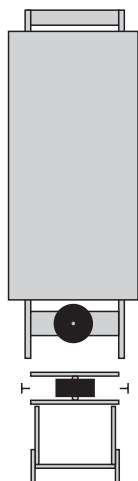

1:1 L HDR

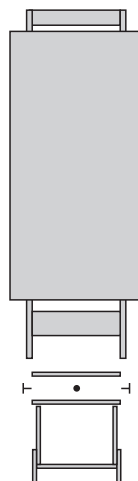

2:1 T HDR

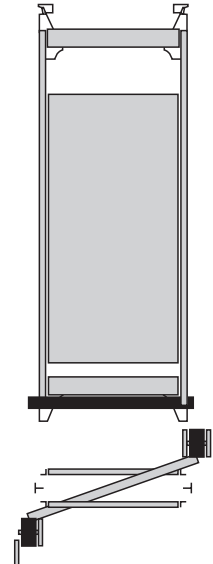

# 2 PANEL TELESCOPIC CABIN DOOR

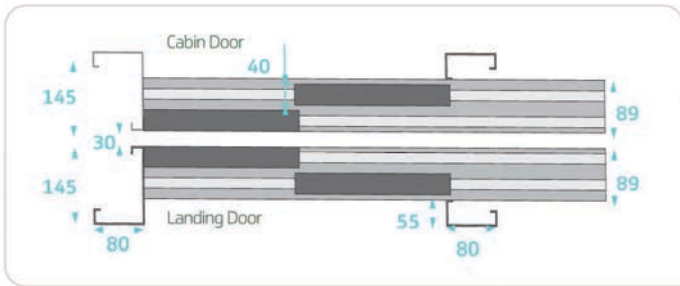
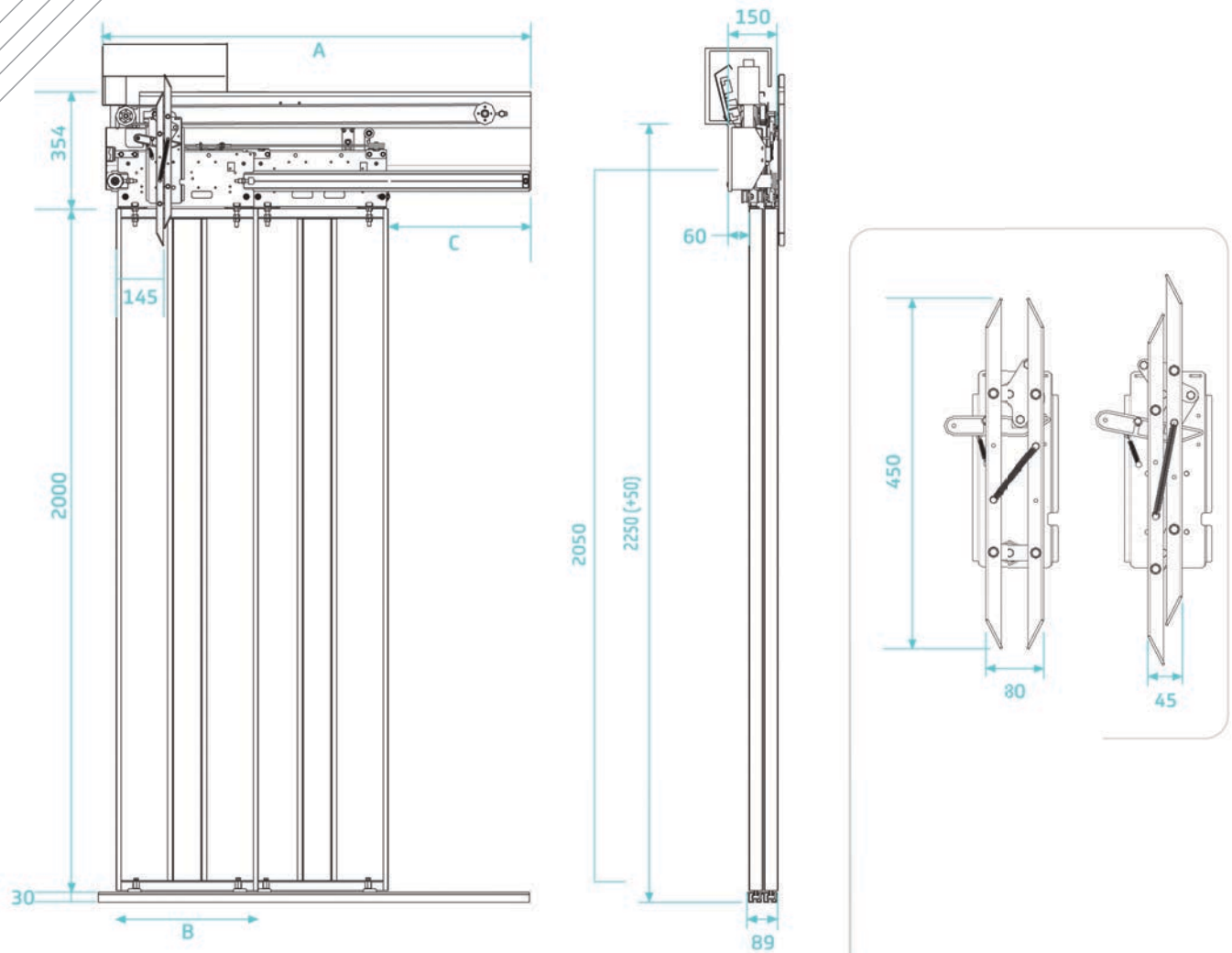

DIMENSIONS				
PL	A	B	C	
700	1100	370	380	
800	1250	420	430	
900	1400	470	480	

## 2 PANEL TELESCOPIC CABIN DOOR

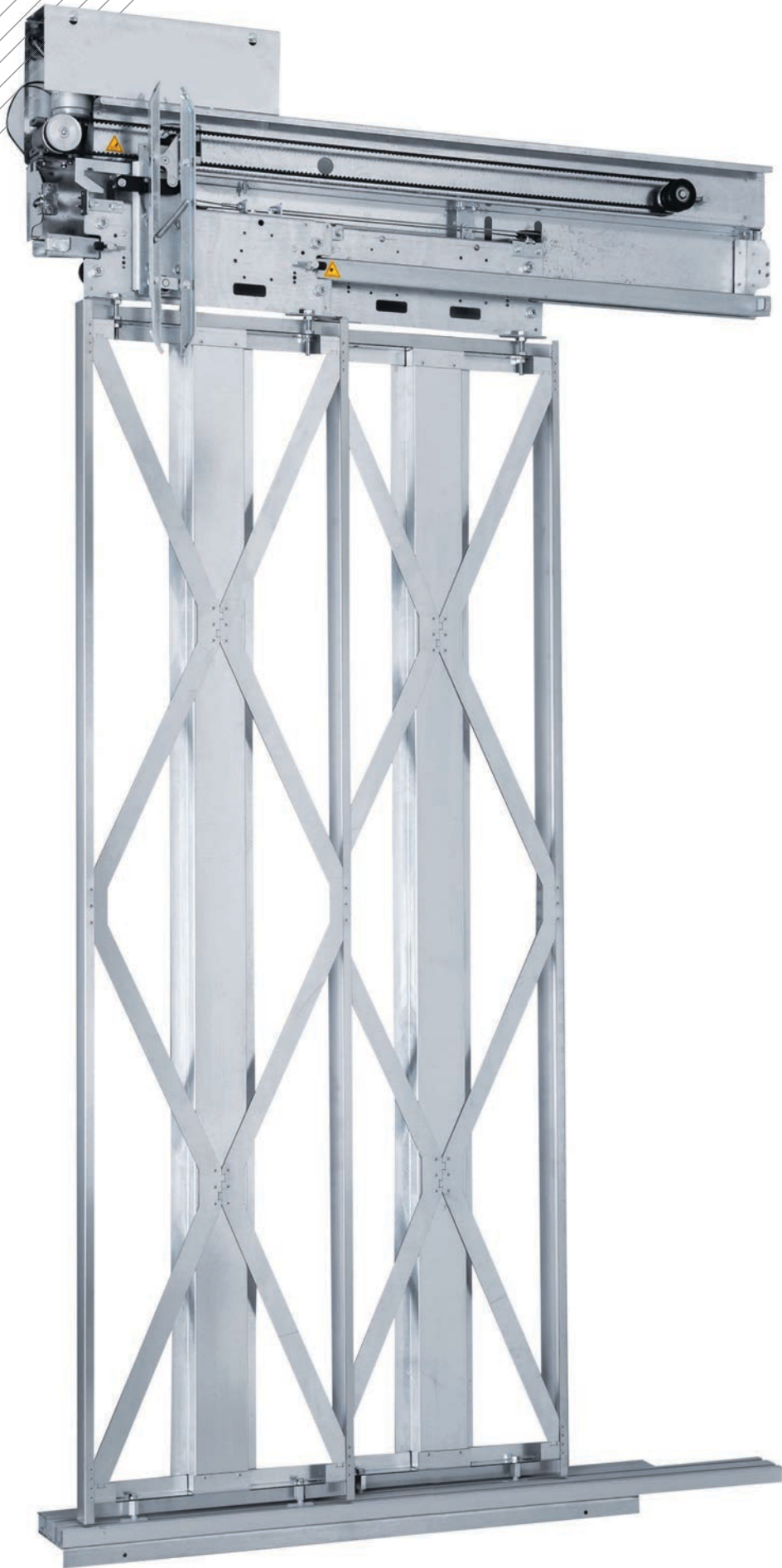

## 2 PANEL TELESCOPIC LANDING DOOR

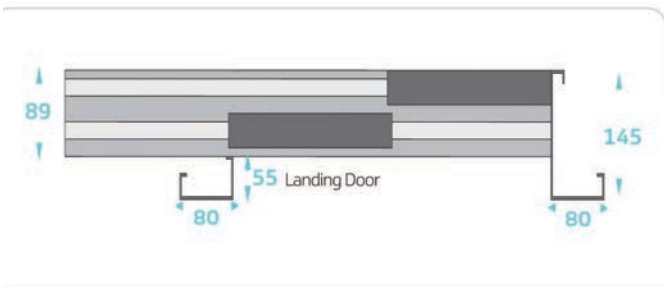
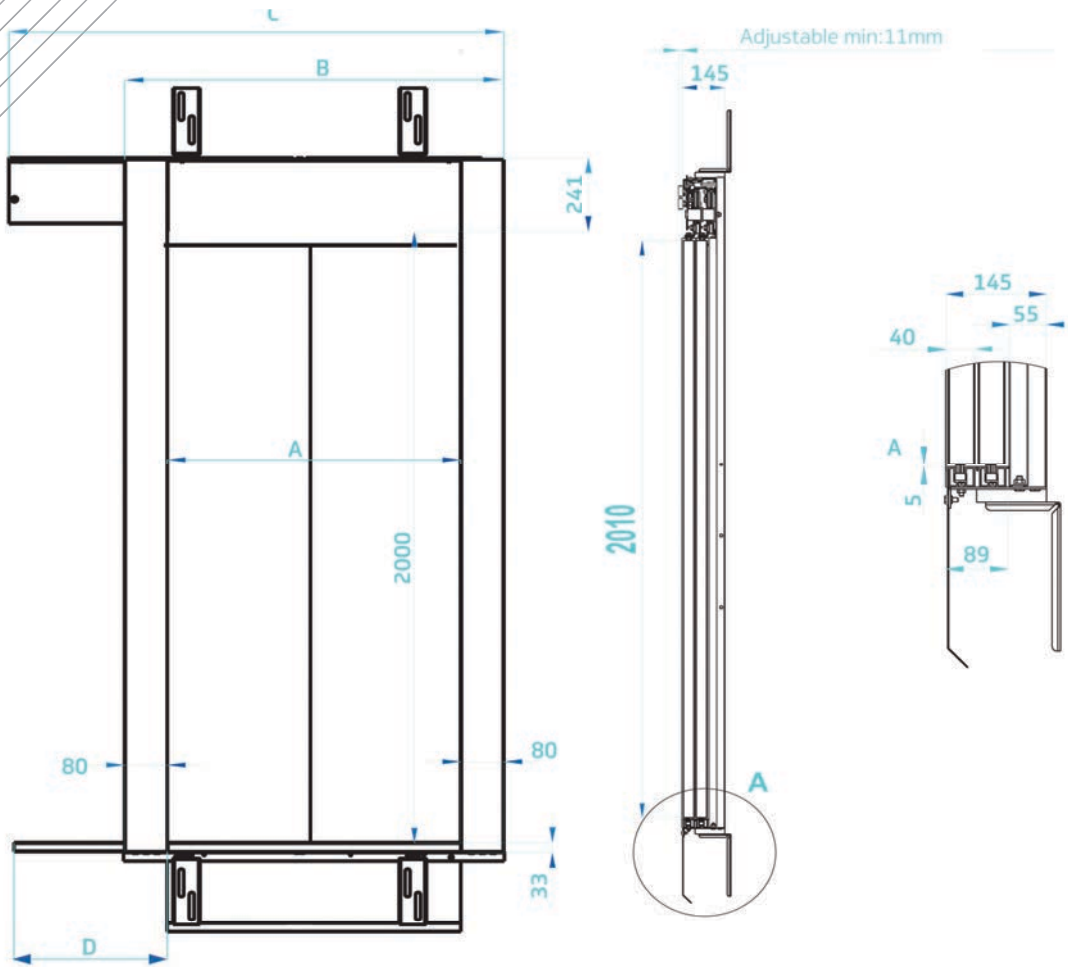

DIMENSIONS			
A	B	C	D
700	860	1150	380
800	960	1300	430
900	1060	1450	480

## 2 PANEL TELESCOPIC LANDING DOOR



## 2 PANEL CENTRAL CABIN DOOR

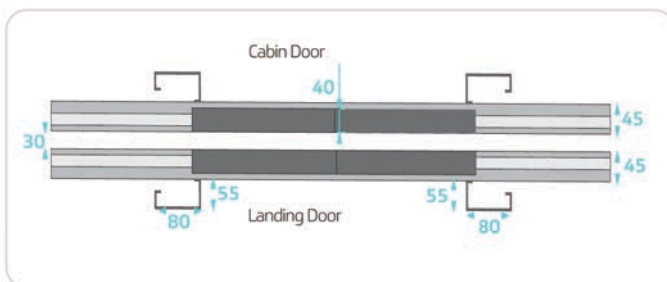
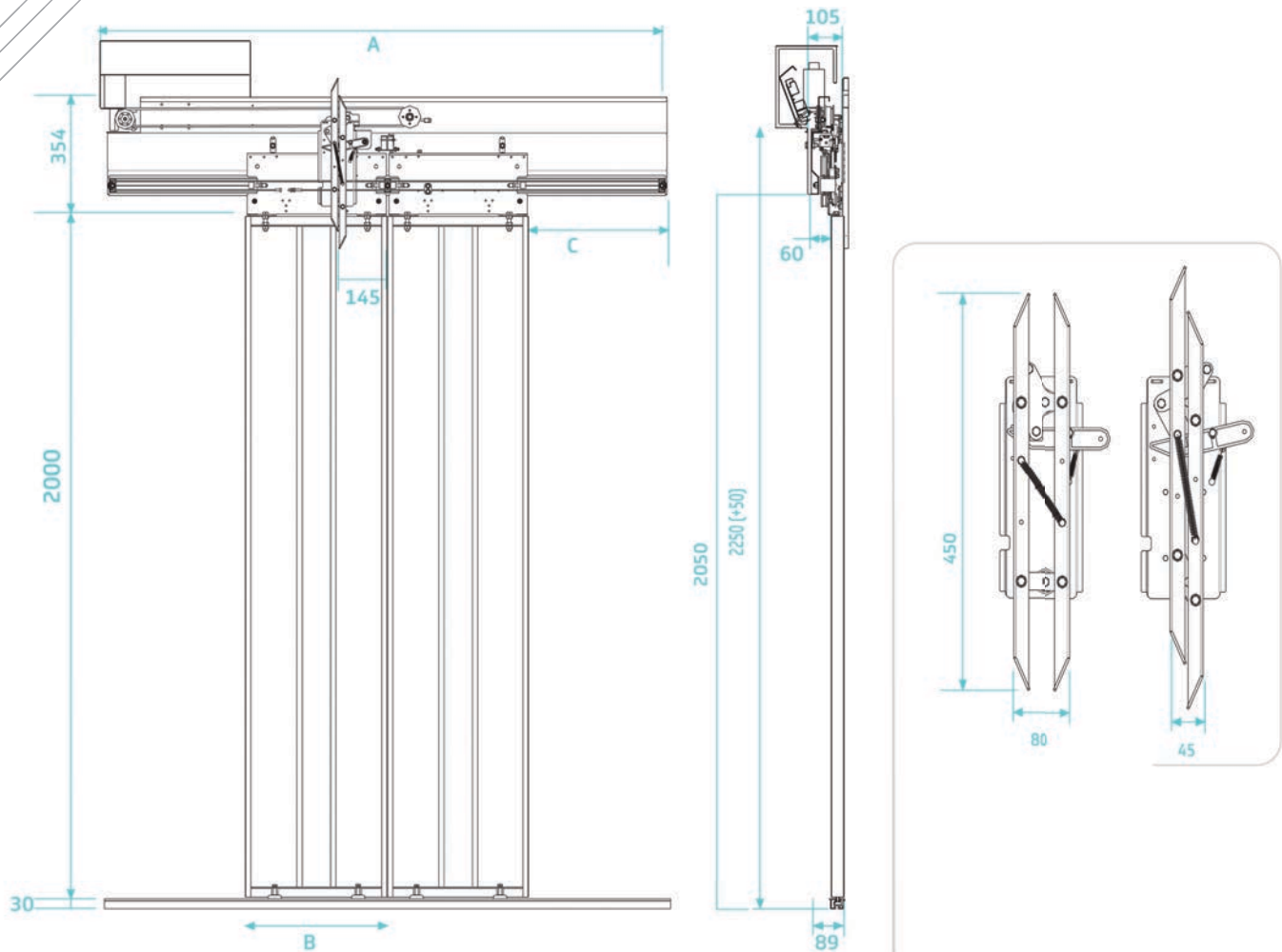

DIMENSIONS			
PL	A	B	C
700	1450	370	380
800	1650	420	430
900	1850	470	480

## 2 PANEL CENTRAL CABIN DOOR



# 2 PANEL CENTRAL LANDING DOOR

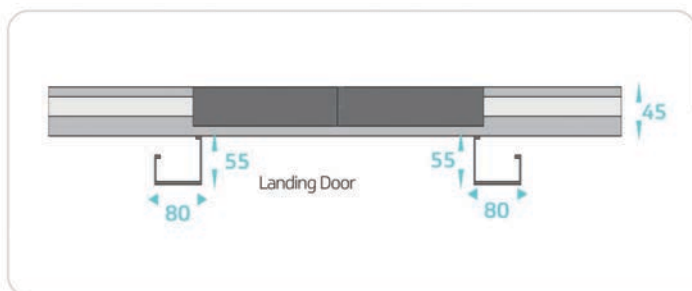
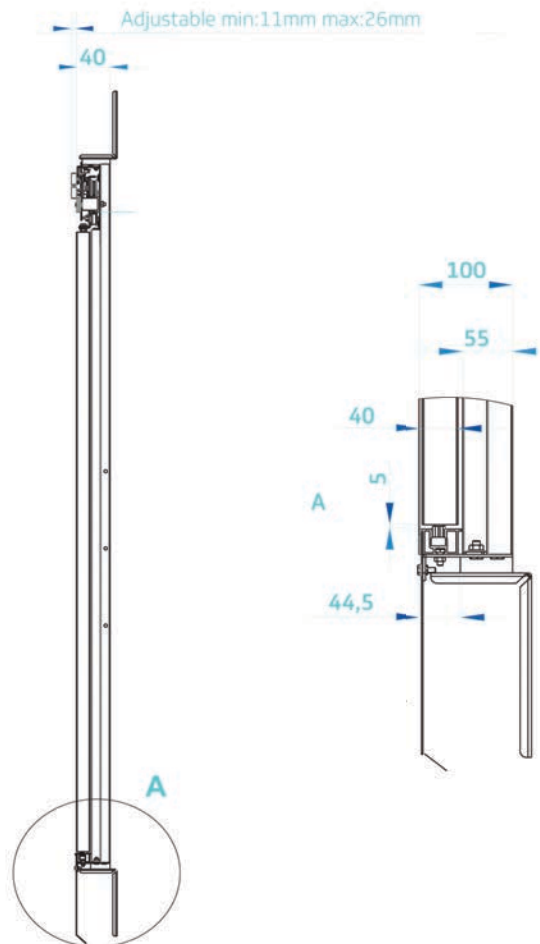
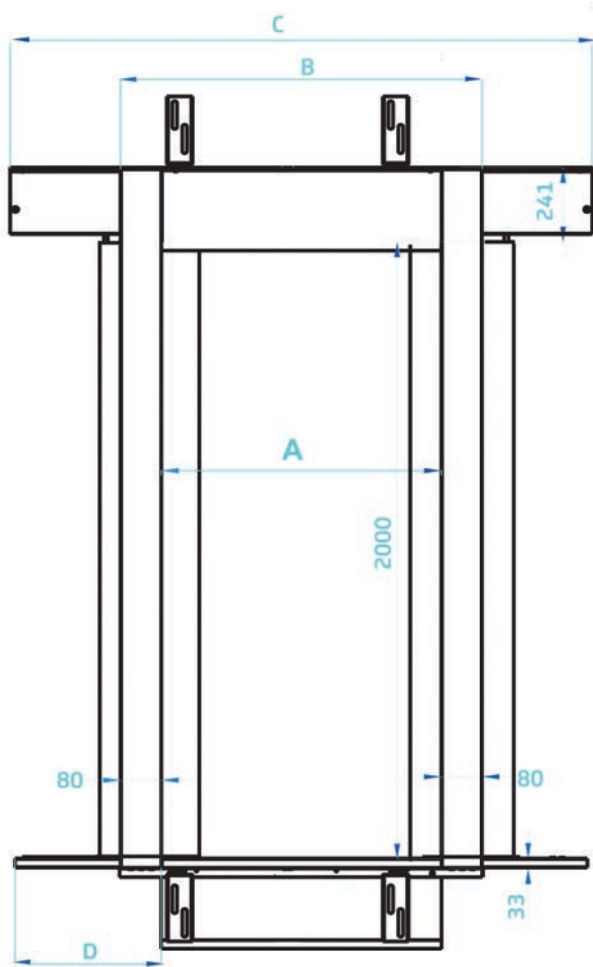

DIMENSIONS			
A	B	C	D
700	860	1450	380
800	960	1650	430
900	1060	1850	480

## 2 PANEL CENTRAL LANDING DOOR

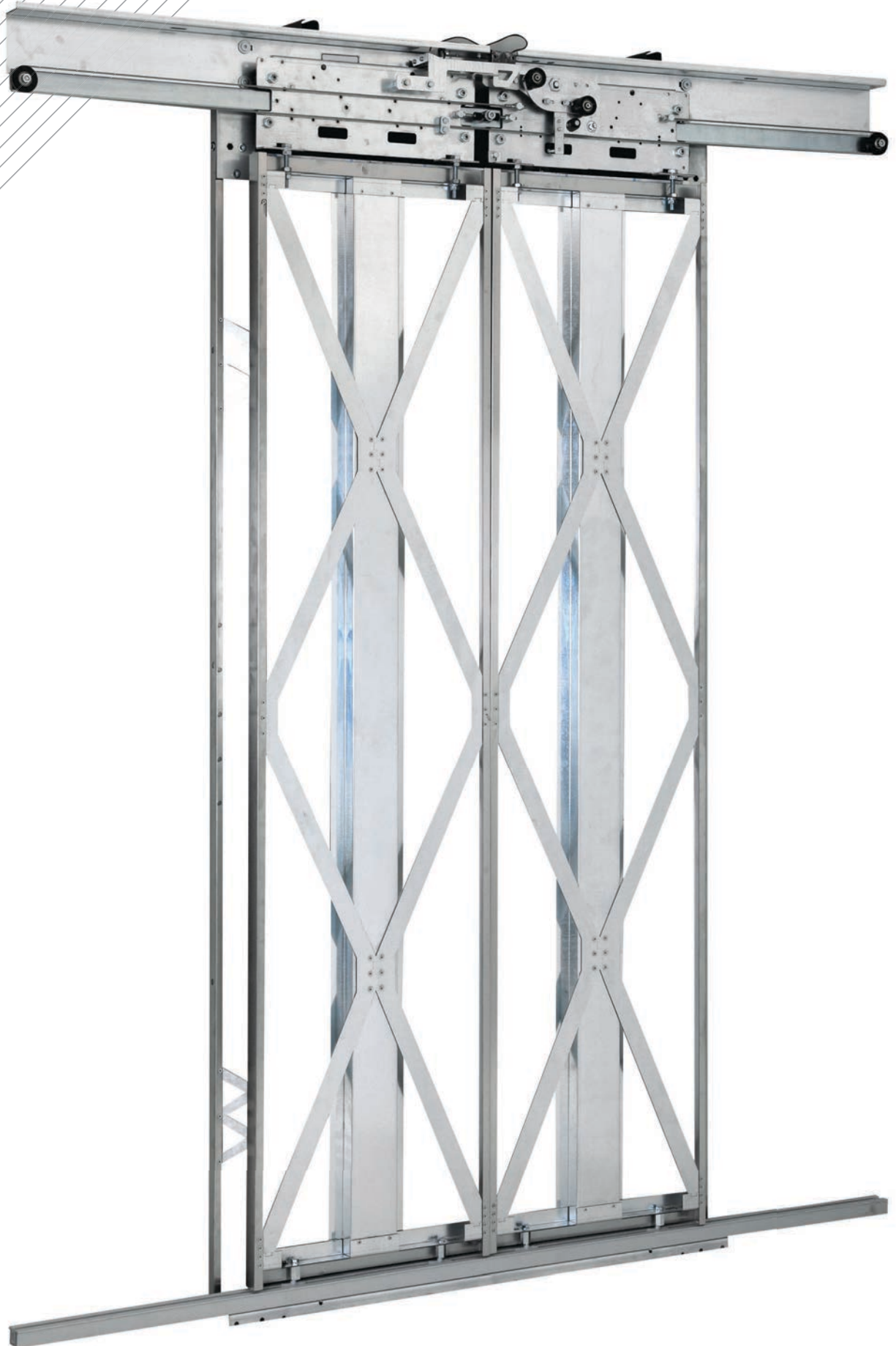

# FOLDING DOORS

D TYPE  
FOLDING CAR DOORS



W TYPE  
FOLDING CAR DOORS

# SWING DOORS

[SD - 101]



[SD - 102]



[SD - 103]

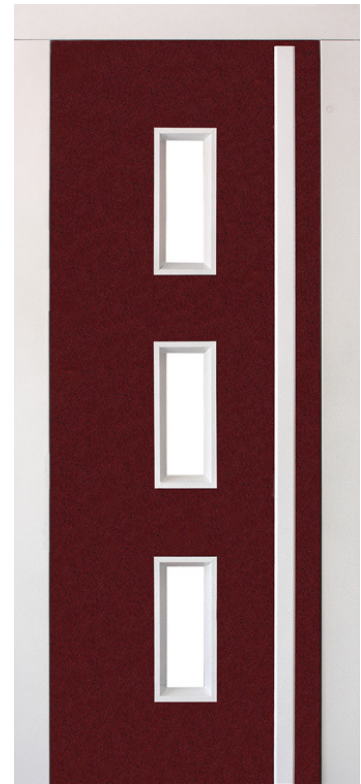

[SD - 104]

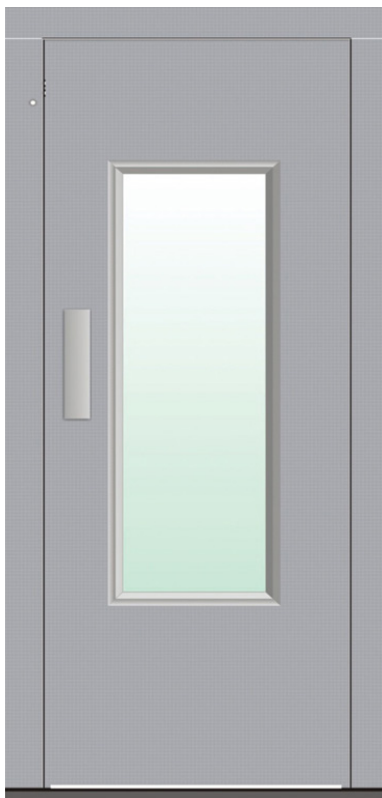

[SD - 105]



turn-key



solutions



# GEARED MOTORS

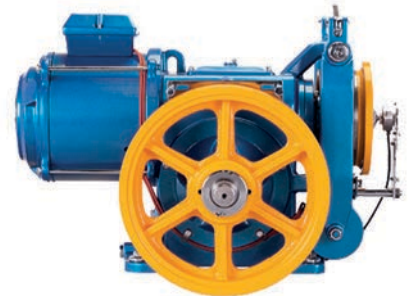

Suspension Type	r	1:1
Capacity Range	Q (kg)	320kg- 7400 kg
Speed Range	V (m/s)	0,63 m/s- 3,20 m/s
Power Range	P (Kw)	4KW - 37 KW
Motor		VVVF
Type of oil		Synthetic gear oil
Travel Distance	m	100 meter with chain
Static load	(kg)	3000 kg -15000 kg

Suspension Type	r	2:1
Capacity Range	Q (kg)	320kg- 13000 kg
Speed Range	V (m/s)	0,3 m/s- 3,20 m/s
Power Range	P (Kw)	4KW - 37 KW
Motor		VVVF
Type of oil		Synthetic gear oil
Travel Distance	m	100 meter with chain
Static load	(kg)	6000 kg -30000 kg

# GEARLESS MOTORS

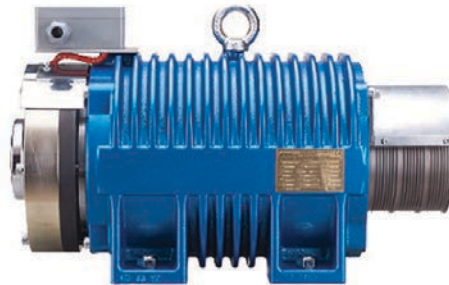
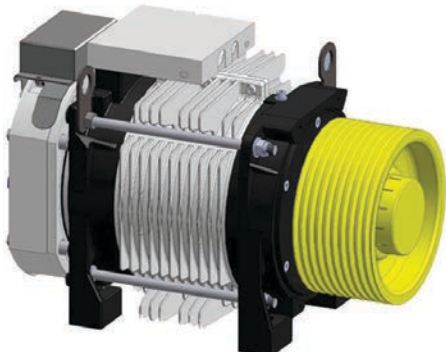
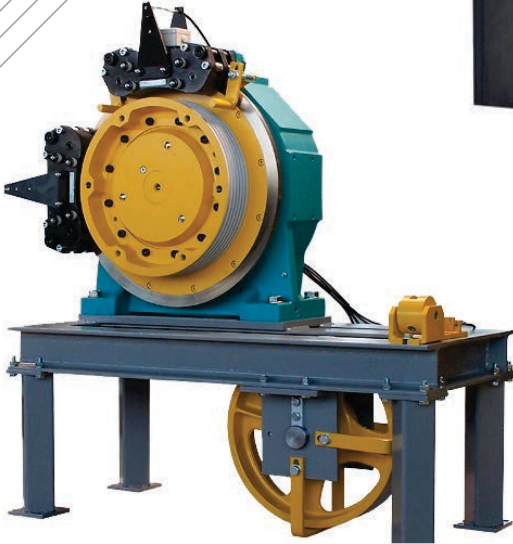

Eco Design



Economic

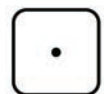

Roomless



Silent

<u>Suspension Type</u>	r	1:1	2:1
<u>Capacity Range</u>	Q (kg)	320kg- 7400 kg	320kg- 13000 kg
<u>Speed Range</u>	V (m/s)	0,63 m/s- 3,20 m/s	0,3 m/s- 3,20 m/s
<u>Power Range</u>	P (Kw)	4KW - 37 KW	4KW - 37 KW
<u>Brake Voltage</u>	V	220 V	220 V
<u>Sheave diameters</u>	mm	240/320 mm	210/240/320/400 mm
<u>Travel Distance</u>	m	27 m (100 meter with chain)	27 m (100 meter with chain)
<u>Static load</u>	(kg)	3500 kg	7000 kg -11000 kg

# INTEGRATED CONTROLLERS

MR TYPE



MRL TYPE



## INTEGRATED DRIVE AND CONTROLLER

1. The elevator integrated drive and controller is designed with closed loop vector controller for higher performance.
2. Zero-speed torque compensation system without load weighing device helps save cost.
3. New PWM dead-zone compensation technology is conducive to energy conservation.
4. Dynamic PWM carrier modulation technology ensures reduced motor noise.
5. The elevator integrated drive and controller is suitable for both synchronous and asynchronous motor.
6. Dual 32-bit embedded microprocessor.
7. Incremental encoder is employed to control synchronous motor

# CONTROL PANELS

GEARLESS CONTROLLER- MRL



GEARLESS CONTROLLER-MR



VVVF CONTROLLER



HYDARULIC CONTROLLER



EXTERNAL RESCUE BOARD



ZAC CONTROLLER



SERIAL BOARD

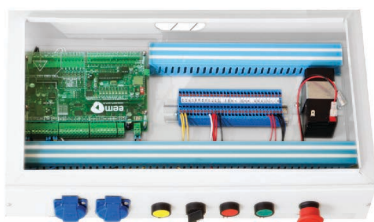

# COPS & LOPS

[ COP - 001 ]



[ COP - 002 ]



[ D - 1 ]



[ D - 2 ]



[ D - 3 ]



[ LOP - 444 ]



[ B - 1 ]



[ B - 2 ]



[ B - 3 ]



[ LOP - 101 ]



[ LOP - 102 ]



[ LOP - 103 ]



[ LOP - 201 ]



[ LOP - 202 ]



[ LOP - 203 ]



# COPS & LOPS

[ COP - 003 ]

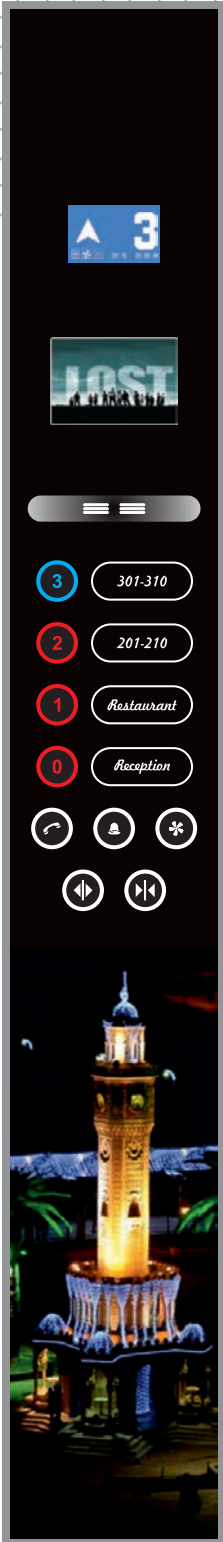

[ LOP - 301 ]



[ LOP - 302 ]



[ COP - 004 ]



[ LOP - 401 ]



[ LOP - 501 ]



[ LOP - 502 ]



[ LOP - 503 ]



# CABLES

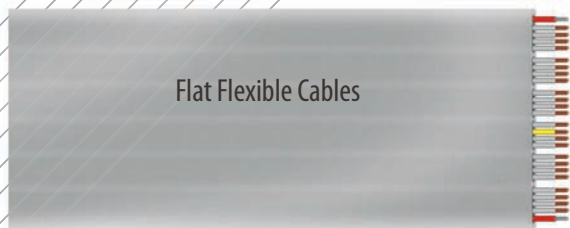

Flat Flexible Cables



Flat Flexible Cables

Article Number	Number of Cores + Nominal Cross-Section	Overall Dimensions (approx.) mm
N12G075	12G X 0,75	4,3 X 34
N16G075	16G X 0,75	4,3 X 45
N20G075	20G X 0,75	4,3 X 55
N24G075	24G X 0,75	4,3 X 66
N30G075	30G X 0,75	4,3 X 78



NYA Cables



NYAF Cables

Number Of Cores And Sction mm <sup>2</sup>	Core Diameter mm	Min. Insulation Resistans at 70 C mohm / km
0,50	2,00	0,014
0,75	2,20	0,013
1	2,30	0,011
1,5	2,80	0,011
2,5	3,40	0,010
4	3,80	0,0087
6	4,30	0,0074
10	5,50	0,0072

Number Of Cores And Sction mm <sup>2</sup>	Core Diameter mm	Min. Insulation Resistans at 70 C mohm / km
0,50	2,10	0,014
0,75	2,30	0,012
1	2,50	0,011
1,5	2,90	0,010
2,5	3,50	0,0095
4	4,35	0,0078
6	4,80	0,068
10	6,20	0,0065



Diafon Cables

Number Of Cores And Sction n x mm <sup>2</sup>	Core Diameter mm	Copper Weight kg/km	Approximate Weight kg/km	Delivery Length m
4 x 0,25	4,30	9,6	26,2	100 / 500 / 1000
8 x 0,25	6,20	19,2	49,2	100 / 500 / 1000
12 x 0,25	7,00	28,8	67,0	100 / 500 / 1000
13 x 0,25	7,10	31,2	71,15	100 / 500 / 1000

# ROPES

## Ropes with Fibre Core (FC)

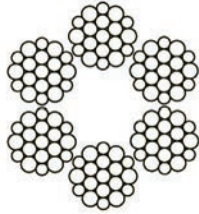

- 6 mm ropes
- 6.5 mm ropes
- 8 mm ropes
- 10 mm ropes
- 11 mm ropes
- 12 mm ropes
- 13 mm ropes

## Ropes with Steel Core (IWRC)

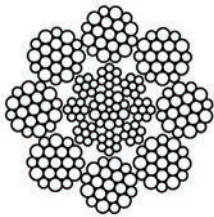

- 6.5 mm ropes
- 8 mm ropes
- 10 mm ropes

## Balance Chain



## Balance Chain Pulley



## Rope Attachment

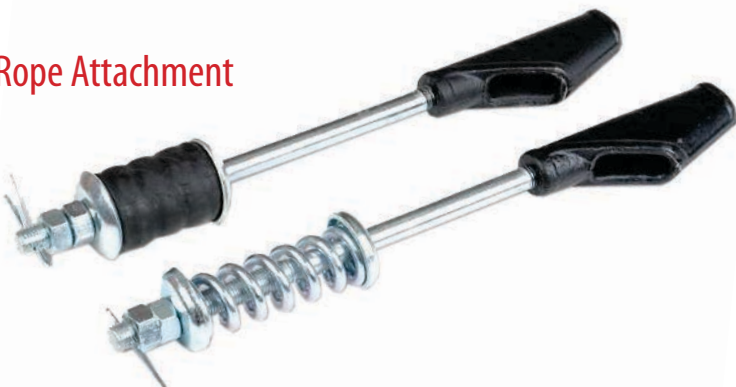

## Rope Clips

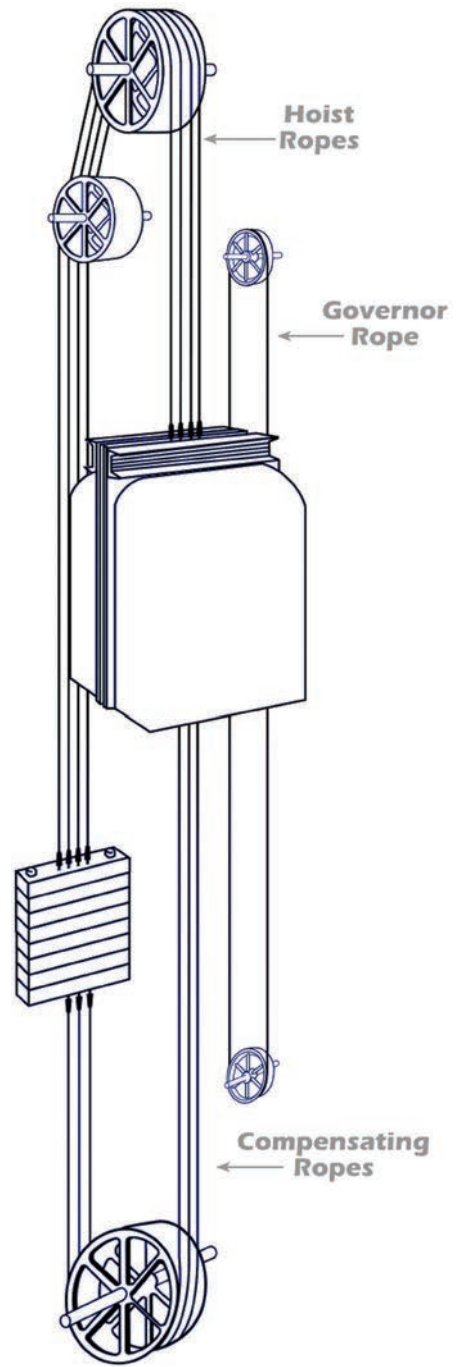

# GUIDE RAILS

## Cold Drawn Guide Rails

T50 / A - 50\*50\*5

T70 / A - 70\*65\*9

T82 / A - 82\*68\*9

T89 / A - 89\*62\*16

T90 / A - 90\*75\*16



## Machined Guide Rails

T70 / B - 70\*65\*9

T75 / B - 75\*62\*10

T89 / B - 89\*62\*16

T90 / B - 90\*75\*16

T114 / B - 114\*89\*16

T125 / B - 125\*82\*16

T127-2 / B - 127\*89\*16

## Brackets



## Fishplates



## Anchor Bolts



## T-Clips



# SAFETY COMPONENTS

## Hydraulic Baffer



V	V1	H	STROKE	CAPACITY
1 m/s	1.15 m/s	540 mm	540 mm	500-2400 kg
1.2 m/s	1.38 m/s	540 mm	540 mm	500-1975 kg
1.6 m/s	1.84 m/s	540 mm	540 mm	500-1750 kg

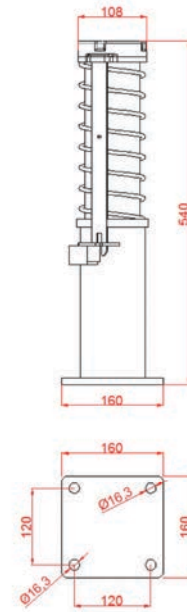

## Overspeed Governor

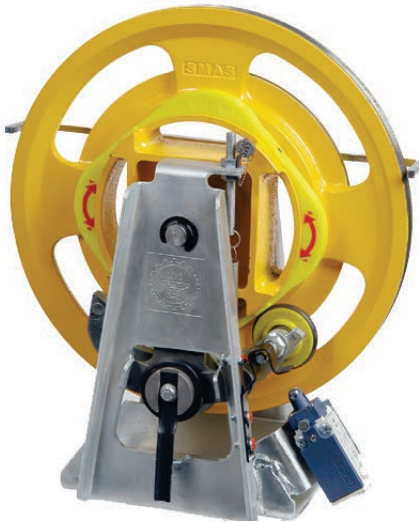

- \* Rated operating speed ( Min) 0.63 m / sec
- \* Rated operating speed ( Max) 1.60 m / sec
- \* Compliance with the Lift Directive 95/16 / EC ( EN 81-1 EN 81-2 )
- \* Bi-directional
- \* According to EN 81 firstly cut off safety contacts and after than brakes
- \* Install to machine room and inside the shaft
- \* Tensioner pulley with safety contact
- \* Adjusted for nominal speed and packed
- \* Suitable for hydraulic and electric lift
- \* Installation is easy , it does not require maintenance



# SPARE PARTS

Safety Gears

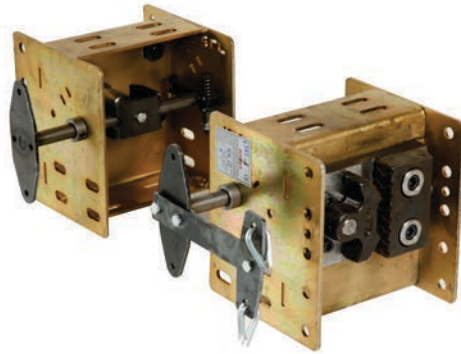

Pulleys



Weight Car Guide Shoes



Car Guide Shoes



L-Type Weight Guide Shoes



Roller Guide Shoes

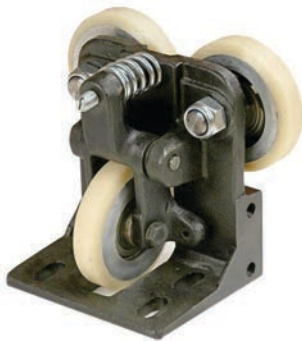

Roller



Guide Shoes Insert 5-9-16mm



Door Lock



Door Shock Absorber



Retiring Cam



# SPARE PARTS

Polyurethane Buffer



Buffer



Photocell



Bi-Stabil



Limit switch



Emergency Stop



Contactors



Encoders



Fan



Rope Holder



Cutter Element



# SPARE PARTS

Cabin Rubber



Motor Wedgd



Lubricator



Oil Cup



Flexible Holder



Rope Attachment



Anchor Bolts



Rope Clips



Brackets



Protection Cover



Barytes 60cm-76cm-96cm





## Dumbwaiter Service Lifts

USAGE	Bars , Restaurants, Villas and Hospitals
RATED LOADS (KG)	40 - 500
MACHINE ROOM	Above or to side
MAXIMUM TRAVEL	20m with Drum, 60m with Pulley
MAXIMUM STOPS	20
CAR SPEED (M/S)	0.15-0,50
DRIVE TYPE	Traction drive

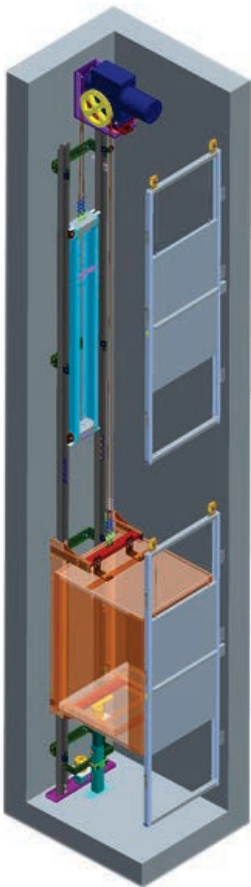

## Description

With loading at serving height and load carrying capacities up to 500kg, the standard our Service Lifts cover most food transport applications.

To satisfy hygiene demands, Stainless steel shelves and floors are supplied as standard. Other stainless steel surface finishes are available as an option.

A special seamless hygienic car is available as an option for more rigorous requirements.

Car protection is an important consideration when moving food as are the optional heated compartments.

Automatic "hands free" doors are available as an option on this range of lifts. A bottom drive variant is available for applications where low headroom is a problem.

## Electric Elevators ( with Machine Room)

USAGE	Villa, Panoramic, Passanger, Disabled, Hospital, Car, Freight Elevators
RATED LOADS (KG)	4 /2400 Up to 133/10.000
MACHINE ROOM	Top , Side, Bottom
MAXIMUM TRAVEL	Up to 70m
MAXIMUM STOPS	Up to 24
CAR SPEED (M/S)	Up to 3,2
MOTOR TYPE	Geared ( VVVF, 2AC)
PIT DEPTH (MINIMUM)	1400
HEADROOM (MINIMUM)	3600
MAXIMUM CAR ENTRANCES	2

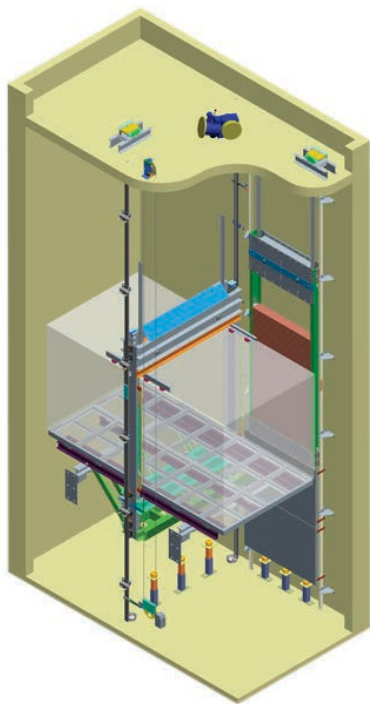

### Description

The development of the electronic driving of lift motors VVVF together with the demand for long travels, brought the classic traction lift again to the market. Following a policy of qualitative choices, a complete range of traction lift packages is offered, satisfying all kinds of applications.

# TRACTION MRL ELEVATORS

## MRL Lifts Specification

USAGE	Villa, Panoramic, Passenger, Disabled, Hospital, Car, Freight Elevators
RATED LOADS (PERSONS/KG)	4/320 - 33/2500
MAXIMUM TRAVEL	100
MAXIMUM STOPS	30
CAR SPEED (M/S)	Up to 2.00 m/s
MOTOR TYPE	Gearless VVVF
PIT DEPTH (MINIMUM)	500
HEADROOM (MINIMUM)	3600 (max u=1.0mps) / 3700
MAXIMUM CAR ENTRANCES	3

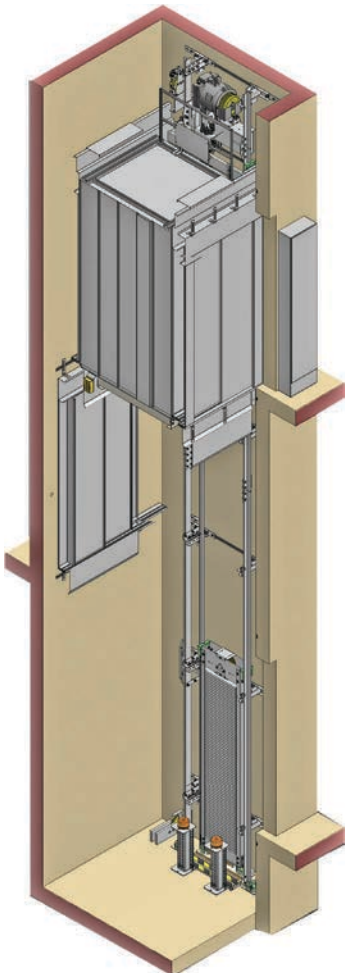
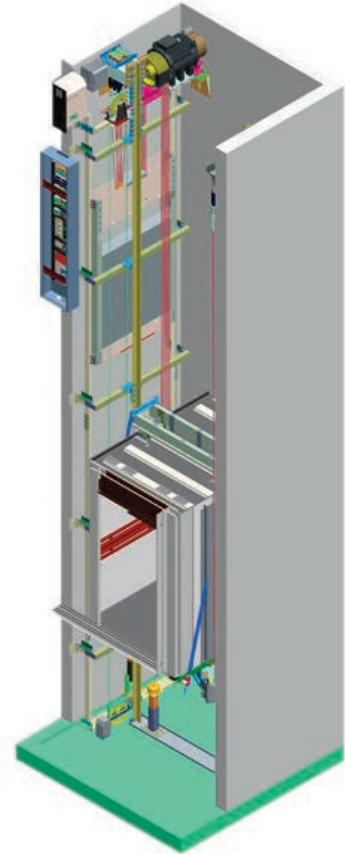

## Description

Our Traction Machine Roomless (MRL) solution for rated loads up to 2500 kg. It is equipped with a premium quality gearless motor and a state of the art inverter that lead to an outstanding ride quality, eliminate noise and achieve very low energy consumption. Furthermore, all lift components are cleverly designed to achieve efficient use of space inside the shaft as well as ease of installation and maintenance.

## Advantages

- Premium ride quality through state of the art technology
- High energy efficiency (especially for high-rise buildings)
- Ease of installation
- Minimal requirements for pit and headroom dimensions
- Type Examination Certificate according to Directive 95/16EC and in compliance with EN81.1/A2, prEN 81.A3 and EN 81.21

## Hydraulic Elevators

USAGE	Villa, Panoramic, Passenger, Disabled, Hospital, Car, Freight Elevators
RATED LOADS (PERSONS/KG)	4/320 6/450 8/630 13/1000
MAXIMUM STOPS	6
CAR SPEED (M/S)	0.63
MOTOR TYPE	Hydraulic Electronic
PIT DEPTH (MINIMUM)	1400
HEADROOM (MINIMUM)	3600
MAXIMUM CAR ENTRANCES	3

## Our Product Range

- 1.2 m/s maximum speed, the most quiet hydraulic system
- Smooth Start / Stop Smooth, extra soft stop / start
- Sensitive and absolute full electronic valve control
- 1,5 - 4,5 kW single phase hydraulic tanks
- 2.7 to 75 kW three-phase hydraulic tanks
- 8-650 l / min pump systems
- Maxi coil, long-lasting valve systems
- 50-280 mm pistons
- 2 and 3-stage telescopic cylinders
- Side 1/1 - 2/1 for single or double piston system
- Bottom of the direct-acting systems
- 2 or 3 points that can be added to split from the pistons
- "CE" certified original Carcasses

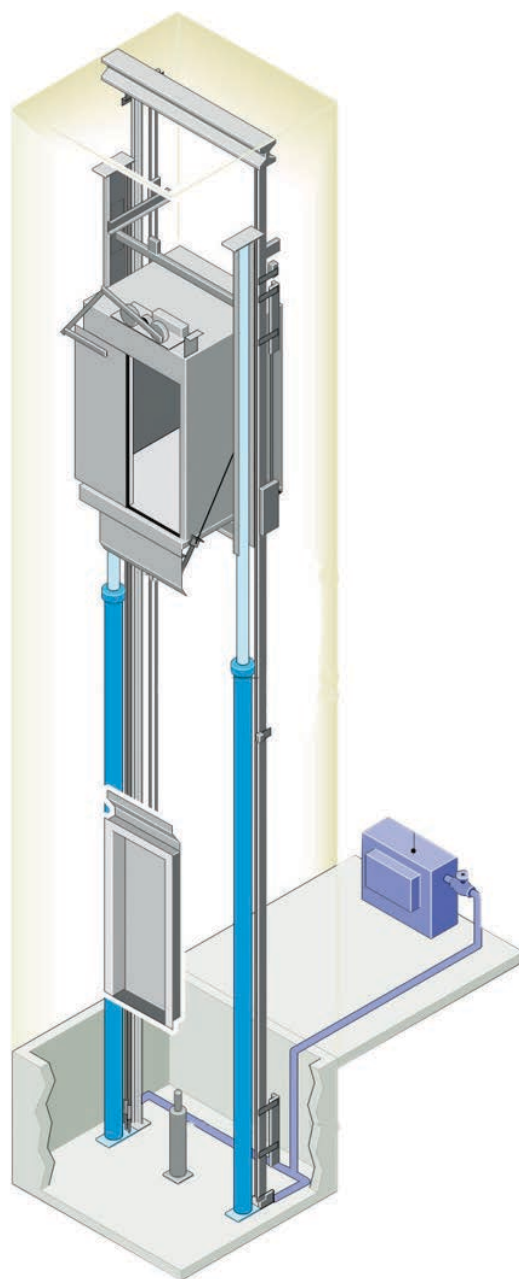

## ESCALATORS / MOVING WALKWAYS



### SAFETY

The Ecolift range of escalators and moving walkways goes that one step further in terms of technology, efficiency and adaptability. A wide range of possibilities ensures that each choice fits perfectly, no matter what the specifics of each case may be

### ADAPTABILITY

Each design is assessed as a whole, which allows us to combine different lift solutions, complementing each other to perfection. A team vision which also applies to the overall development of the design.

### EFFICIENCY



Our range includes options which can support very high levels of traffic, offering optimum performance in extremely demanding conditions such as those at an airport or metro station.

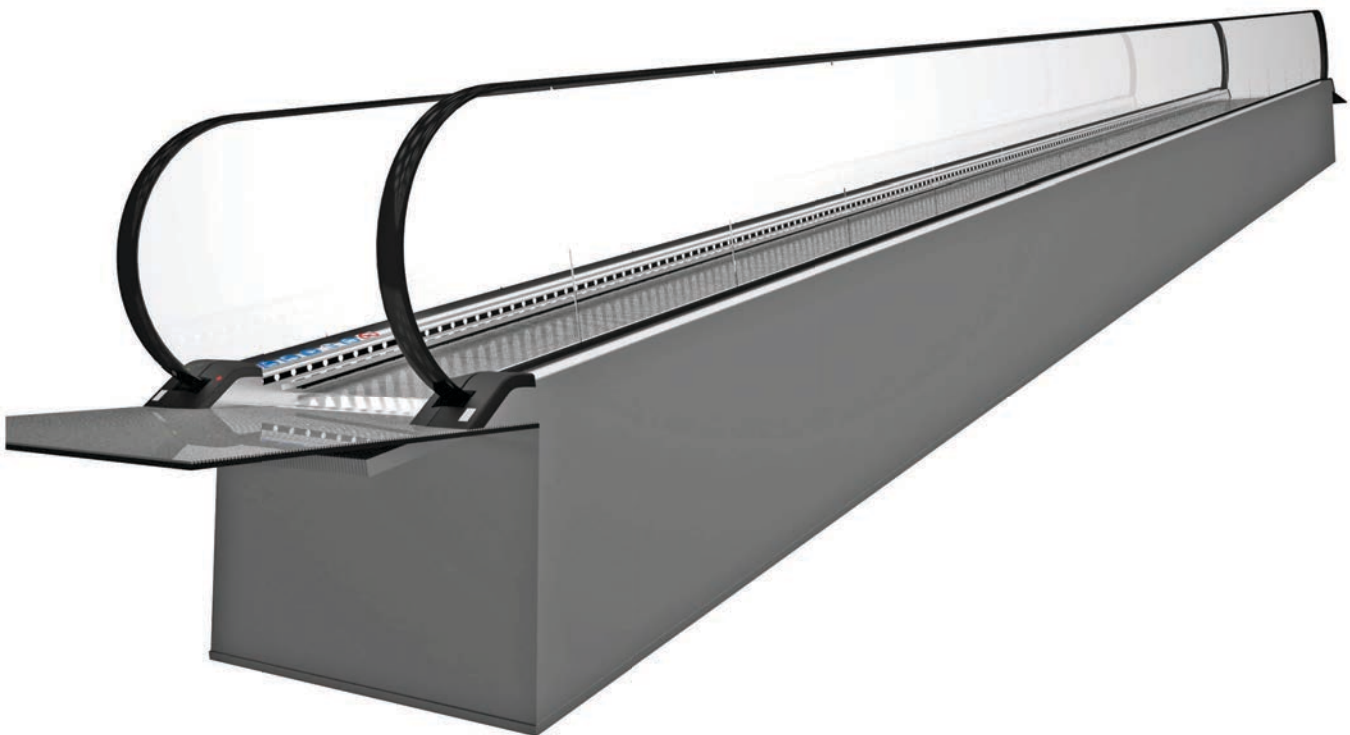

### RELIABILITY

The Ecolift range is backed up by a team of experts who work on each stage of the design development and on the subsequent performance of the product, even from the design of each model.



# ESCALATORS / MOVING WALKWAYS

ESCALATORS		
TYPES	Comercial 	Heavy Duty 
Installation	Indoor/Outdoor (*)	
Working hours (hours per day)	16 hours	20-24 hours
Capacity (persons per hour)	Up to 7300	
Inclination (°)	30° / 35°	
Speed (m/s)	0.5 / 0.65	
Width of tread (mm)	600/800/1000	
Vertical rise (m)	2.0 m to 7.5 m	2.0m to 12 m
Motor Type	One Speed-VVVF	
* Optional		

MOVING WALKWAYS		
TYPES	Trolley 	Long way 
Installation	Indoor/Outdoor (*)	
Working hours (hours per day)	16 hours	
Capacity (persons per hour)	Up to 6000	
Inclination (°)	10° / 11°/12°	0° / 6°
Speed (m/s)	0.5	
Width of tread (mm)	800/1000	1000/1200/1400
Vertical rise (m)	2m-8m	0-8m
Motor Type	One Speed-VVVF	
* Optional		

## OPTIONS

- \* Safety brake on the main shaft
- \* VVVF
- \* Automatic lubrication system
- \* Balustrade / skirting board lighting
- \* Traffic lights
- \* Handrail speed monitor
- \* Error display
- \* Auto start-up (photocell or door track contact)
- \* Remote control
- \* Colour handrails
- \* Colour steps
- \* Frame coating (rustproof or primer)
- \* Preparation for outdoors (anti-rust nuts and screws, oil separator, flooding of shaft)



# DISABLED AND STAIRLIFTS

[ DL - 001 ]



[ DL - 002 ]



[ DL - 003 ]



[ DL - 004 ]



[ DL - 005 ]







# NOTES



